

1. FOUR PIN CROSS ARM

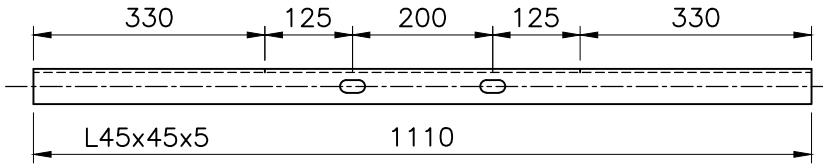

ELEVATION

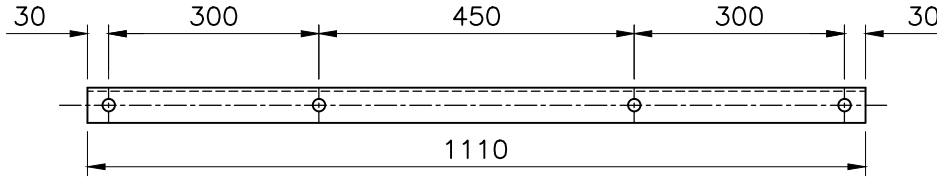

PLAN

2. TWO PIN CROSS ARM

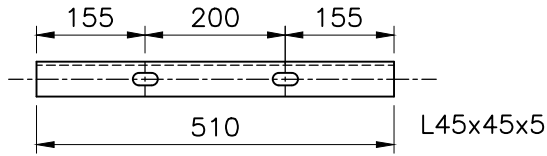

ELEVATION

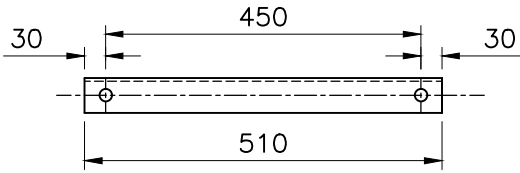

PLAN

3. SINGLE -TOP SUPPORT

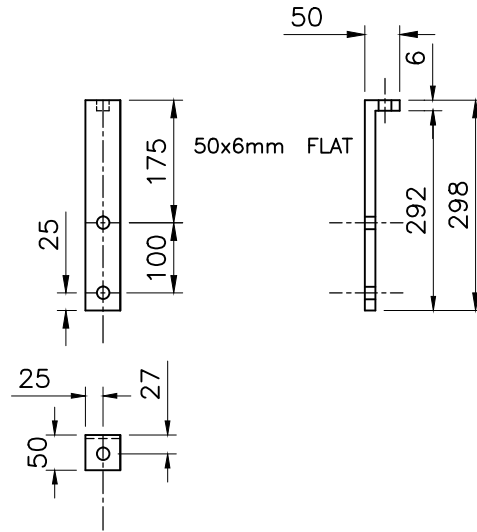

NOTES:-

1. ALL DIMENSIONS ARE IN mm.
2. ALL HOLES ARE 18mm ϕ FOR 16mm ϕ BOLTS UNLESS OTHERWISE STATED.
3. ALL SLOT HOLES ARE 18x36mm UNLESS OTHERWISE STATED
4. NOT TO SCALE.

BILL OF MATERIALS

| SR. NO. | DESCRIPTION | SECTION | LENGTH (In mm.) | Kg./Mtr. | Total Wt./ Piece (In Kg.) |
|---------|---------------------|---------|-----------------|----------|---------------------------|
| 1 | SINGLE -TOP SUPPORT | 50x6 | 348 | 2.4 | 0.835 |
| 2 | TWO PIN CROSS ARM | 45x45x5 | 510 | 3.4 | 1.734 |
| 3 | FOUR PIN CROSS ARM | 45x45x5 | 1110 | 3.4 | 3.774 |

Signatures

All dimensions are in mm unless otherwise stated.

Chd

[Signature]
AGM (QS&S)

DETAILS OF
FOUR PIN AND
TWO PIN CROSS ARM
& SINGLE TOP
SUPPORT
(FOR LT SYSTEM)

ಬೆಂಗಳೂರು



BESCOM

Approved:

[Signature]
General Manager, (Elec.)
QS&S

Sub

[Signature]
DGM (QS&S)

SCALE: N.T.S

DRG.NO.BESCOM/GM/QS&S/32
REV-002 DATED:24-11-2018