

PLAN AT TOP

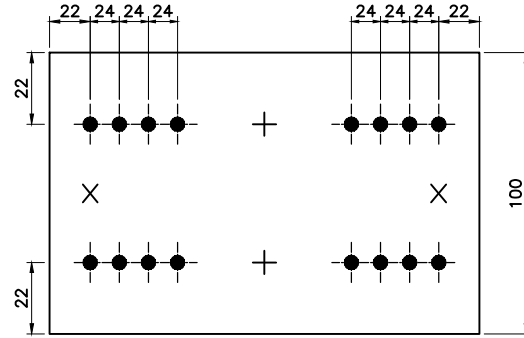

SECTION A-A

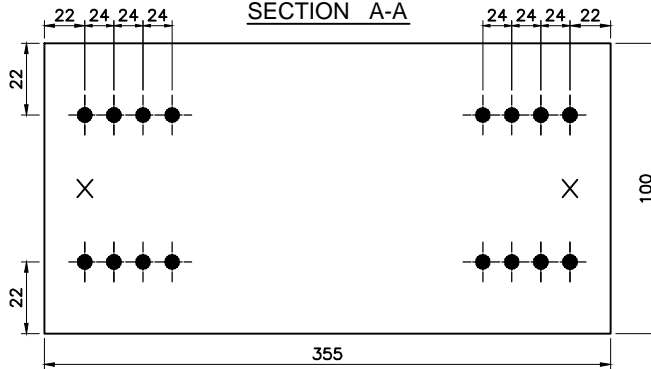

PLAN AT BOTTOM

- DENOTES TENSIONED WIRES
- × DENOTES UNTENSIONED WIRES
- + POSSIBLE POSITION OF EARTH WIRE

TECHNICAL GUARANTEE PARTICULARS:

SECTION	A)TOP	185x100mm
	B)BOTTOM	355x100mm
QUANTITY OF CONCRETE		0.243m ³
CONCRETE GRADE		M-40
STEEL QUANTITY PER POLE		15.94 Kg.
OVERALL LENGTH SUPPORT		9.0 Mtr
PLANTING DEPTH		1.7 Mtr
DIAMETER OF PRESTRESSING WIRE		4mm
NUMBER OF TENSIONED WIRES		16 NOS
NUMBER OF UNTENSIONED WIRES		2 NOS
PRE-TENSIONED APPLIED TO EACH 4mm WIRE		1760 Kgs
MINIMUM CUBE STRENGTH OF CONCRETE AT 28 DAYS		420 Kg/Cm ³
CLEAR COVER		20mm
FACTOR OF SAFETY		2.0
WORKING LOAD		300 Kgs
ULTIMATE LOAD		600 Kgs
WEIGHT OF POLE(THEORITICAL)		607 Kgs
LOAD APPLICATION AT A POINT FROM THE TOP		600 mm
ULTIMATE TENSION STRENGTH FOR 4mm WIRE		17500 Kg/Cm ²

Signatures

All dimensions are in mm unless otherwise stated.

Chd

[Signature]
AGM (QS&S)

Sub

[Signature]
DGM (QS&S)

SCALE: N.T.S

**REINFORCEMENT
DETAILS
OF 9.0 M 300 Kg.
PRESTRESSED CEMENT
CONCRETE POLE
(FACTOR OF SAFETY=2.0)**

ಬೆಂಗಳೂರು



BESCOM

Approved:

[Signature]
General Manager, (Elec.)
QS&S

DRG.NO.BESCOM/GM/QS&S/55
REV-003 DATED:23-12-2019